

How do you shut off the water...

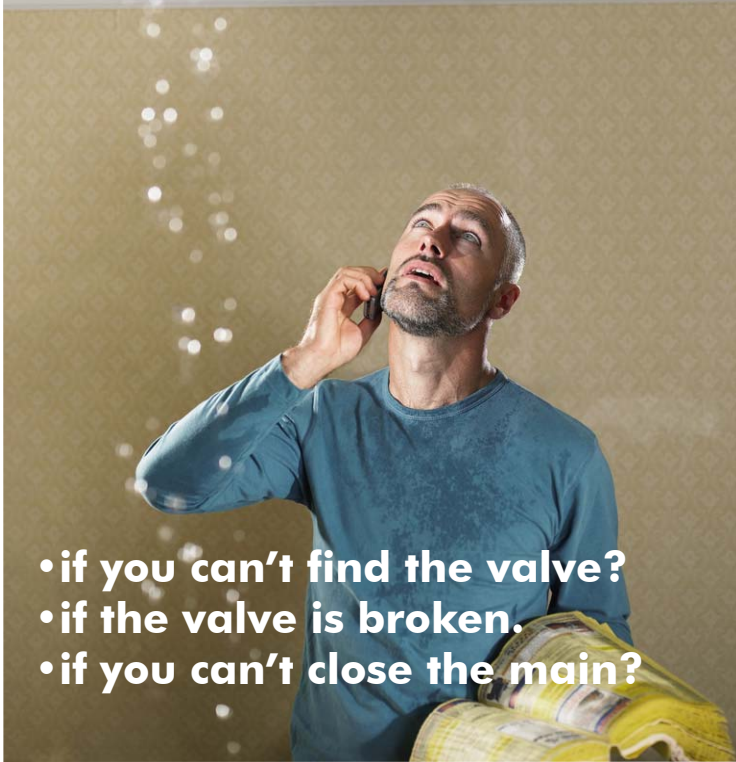

- if you can't find the valve?
- if the valve is broken.
- if you can't close the main?

Go from mess to "Yes!"



with EasyFit®

# EasyFit® Isolator Valve



For use on live, pressurized water lines!

Developed and sold in Europe for over 10 years, the EasyFit® isolator valve is now available in the USA.

Used on pressurized copper water lines, this innovative product is more than just a time saver. It's a realization:

"...if I only had this last time..."

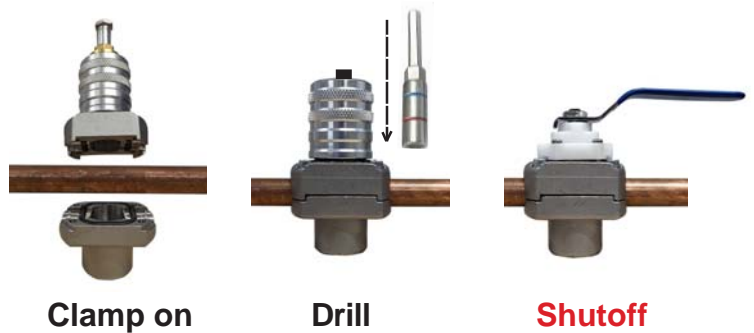

Housed in a 304 stainless steel body, the EasyFit®'s patented **CoreCutter** is a valve-port and blade all-in-one. It cuts pipe and positions the valve port in one motion.

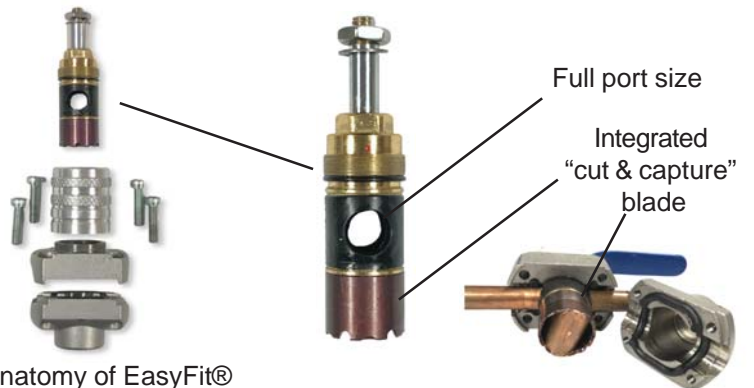

Anatomy of EasyFit®

# HOT TAP & SHUT OFF FOR COPPER PIPE!

## EasyFit® Isolator Valve

- Emergency hot-tap and shutoff of pressurized water lines
- Emergency inline isolation of malfunctioning valves
- Innovative & intuitive design
- **For water & glycol service only**
- 304 Stainless Steel Body
- Rated: 185° Farenheit  
230 PSI

Part#	Description
1735002	EasyFit for 1/2" copper
1735004	EasyFit for 3/4" copper
1735006	EasyFit for 1" copper



US Patent# 8613291B2



GO TO [WAL-RICH.COM](http://WAL-RICH.COM) FOR  
INSTALLATION VIDEO!



**Step 1:** Clamp upper and lower body around clean copper pipe, fully seating the gaskets. **Additional pipe support is recommended.**

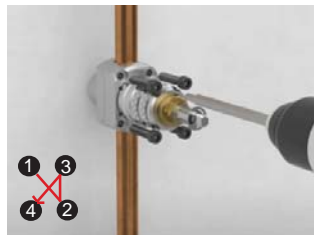

**Step 2:** Fasten body bolts using **balanced, alternating "star" pattern**. **Manually tighten bolts** with hex key until upper and lower are flush.



**Step 3:** Using drill on **low speed, high-torque setting**, drive cutter plug into valve. Use color reference lines as stop point. **Maintain consistent pressure** through **\*3 stages\*** as copper pipe is cut and seated.



**Step 4:** Remove drill collar by hand and discard.



**Step 5:** Using adjustable wrench, align cutter plug with body by **lining up the red dots**. This confirms that the port in cutter plug is **open**.



**Step 6:** Remove the split poly tube from spindle. **Do not remove the circlip.**



**Step 7:** Fit white plastic valve cap over spindle. **Gently push cap down to contact point with upper body**. Drive cap screws with phillips screwdriver.



**Step 8:** Fit handle over spindle and use half nut to secure in place. Turn handle 90° to close valve. Valve action should be smooth with positive shutoff.